

CHRYSLER A904 (TORQUEFLITE 6, 30RH) 31RH (A998) / 32RH (A999) ... 3 SPEED - RWD

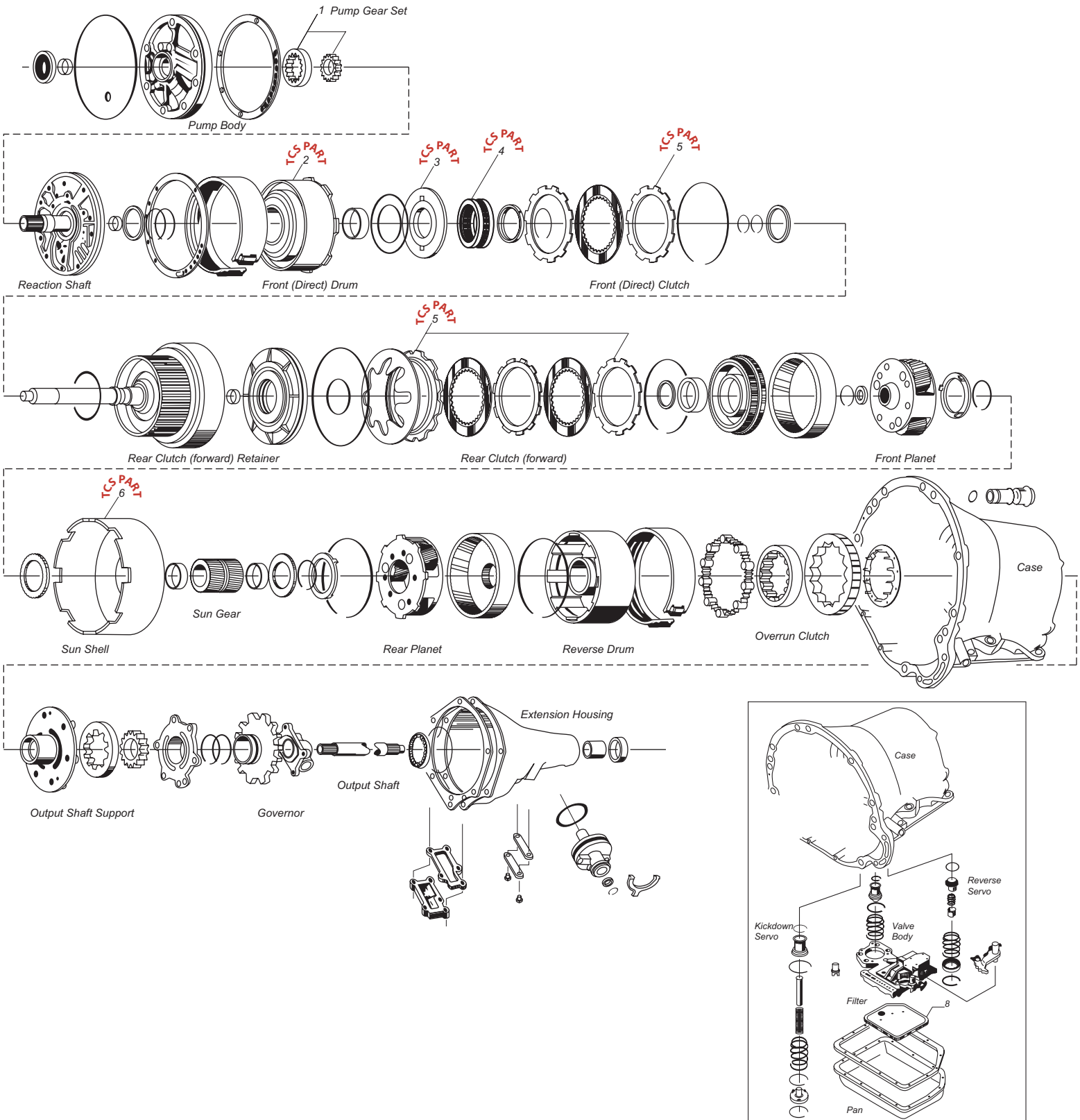

A904 HIGH PERFORMANCE PRODUCTS

Manufactured In-House by TCS Products

904 Steel Front Drum & 24 Spring Return Module Kit: Product #K123800S

TCS Products manufactures this performance A904 steel drum kit for high performance Dodges. The drum is stronger and safer than the O.E.M. cast iron drum.

- * Front drum is made from AIA/SAE 1040-1045 medium carbon billet machinery steel.
- * Kit contains a billet aluminum piston with anti-spin locking tabs
- * Will hold up to 5 frictions.
- * Dual feed apply passages.
- * The drum and piston have been made 28% larger in the piston apply area = more clamping force.
- * The kit also includes 2 solid sealing rings for ZERO leakage and a TCS 24 spring return module (part# 128216)



904 Aluminum Direct Drum Kit & 24 Spring Return Module: Product #K123800PT

- * Drum is made from 7075-T6 billet aluminum, weighs 2.30 lbs.
- * Billet aluminum piston.
- * Will hold up to 6 friction plates.
- * 24 spring return module.



904 Front Drum 24 Spring Return Module: Product #128216

- * Manufactured by TCS from 7075-T6 billet aluminum.
- * 24 springs and comes with snap ring.
- * Provides just the right spring pressure for positive piston return function.
- * Reduces overlap lag between the apply/release.



904 Aluminum Pressure Plate Kit: Product #123804

CNC machined from 7075-T6 billet aluminum.

- * 1- Aluminum beveled pressure plate (part#123901PP) is 65% lighter than the O.E.M. version, 0.30 lbs. versus 0.85 lbs.
 - * 2- Aluminum pressure plate (part#123900PA) weighs 0.45 lbs. versus 1.05 lbs. O.E.M.
- This strong and light weight kit includes 3 plates. Available in select thicknesses.



904 Heavy Duty Band Strut: Product #12717HD

- * Case hardened 1018 carbon steel for added strength and durability.
- * 100% thicker than O.E.M. version at .240"



904 Ultra-Lite Sun Shell: Product #121451

For the serious enthusiast looking to reduce every possible ounce of weight from the transmission

- * 2.85lbs versus the 3.75 lb stock unit. Almost 1lb. of weight reduction!
- * Gold dichromate plated.

Please specify outside diameter of sun shell when ordering;
6" O.D., 6-1/8" O.D. or, 6 3/8" O.D.

