

FIGURE 1

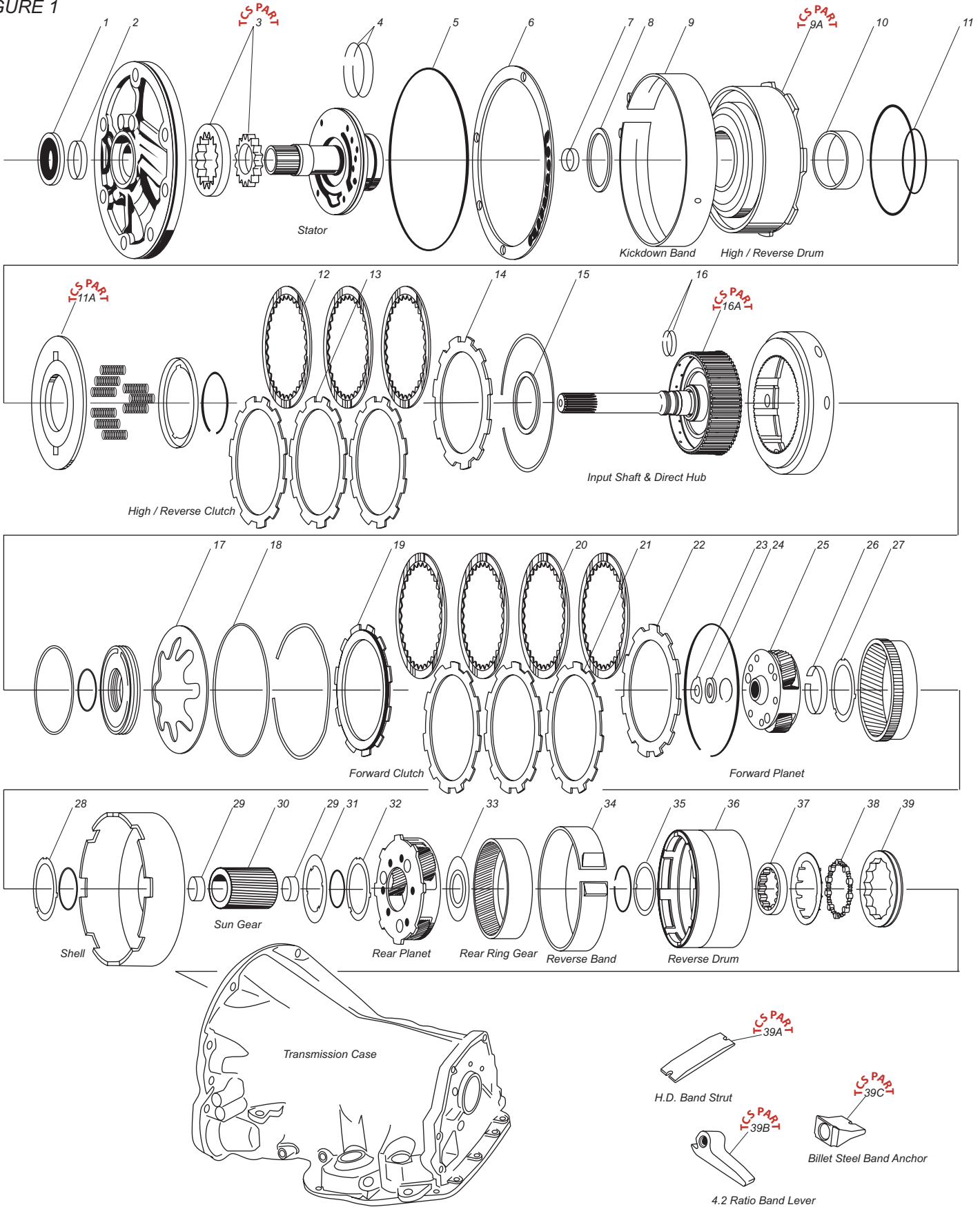
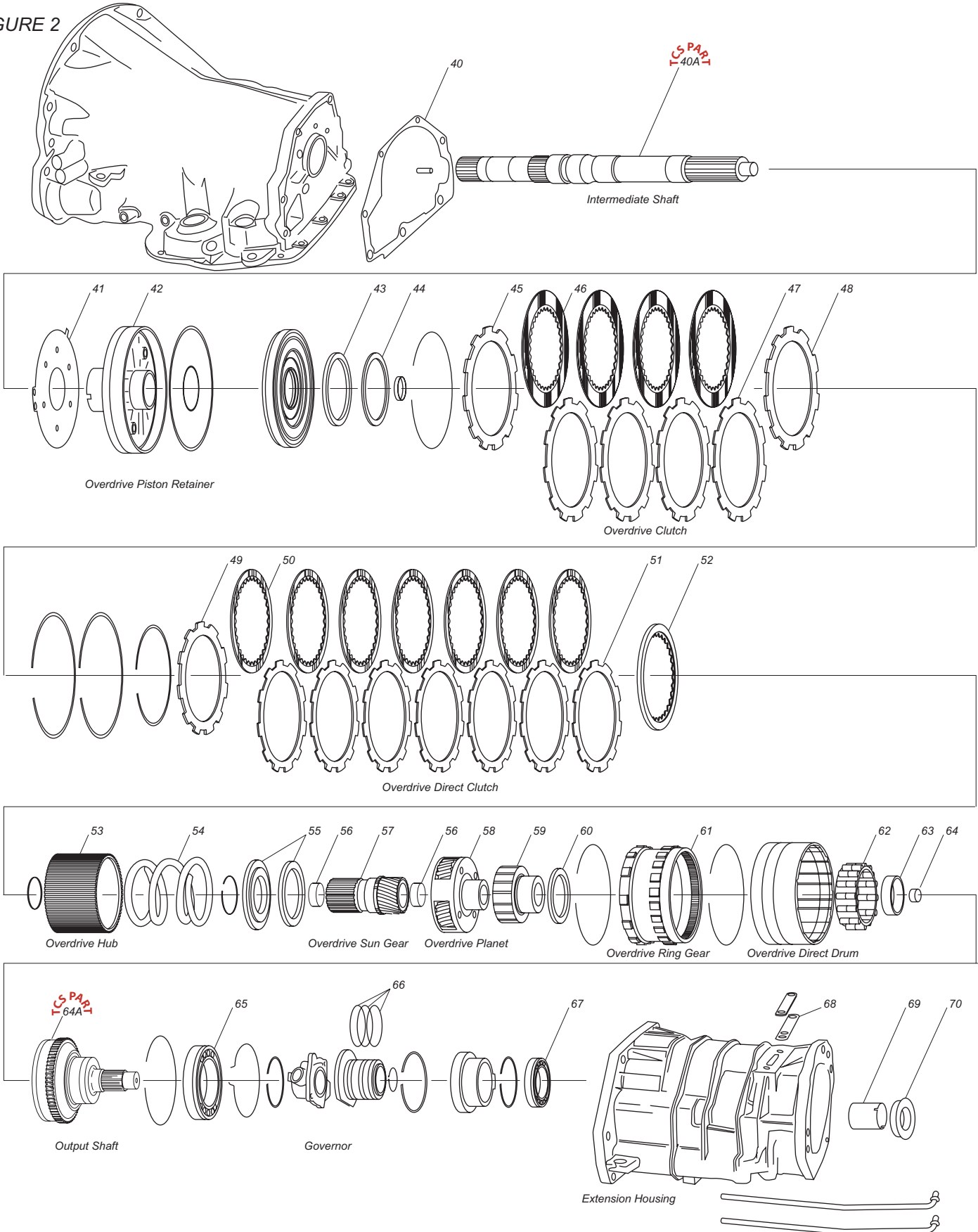

FIGURE 2



CHRYSLER A518 / A618 (46RH / 47RH / 48RE) - RWD 4 Speed

1	Front Pump Metal Clad Seal	25	Front Planet	48	Overdrive Pressure Plate
2	Front Pump Body Bushing	26	Wear Sleeve Bushing	49	Overdrive Direct Reaction Plate
3	Front Pump Gears	27	Front Planet Carrier	50	Overdrive Direct Friction
4	Reaction Shaft Support Sealing Rings	28	Sun Gear Shell (Front) Thrust Washer	51	Overdrive Direct Steel
5	Front Pump to Case Seal	29	Sun Gear Bushing	52	Overdrive Direct Pressure Plate
6	Front Pump to Case Gasket	30	Sun Gear	53	Overdrive Direct Clutch Hub
7	Reaction Shaft Bushing	31	Sun Gear Shell (Rear) Thrust Plate	54	Overdrive Clutch Coil Spring
8	Thrust Washer and Bearings (PumpSelective)	32	Rear Planet Carrier	55	Overdrive Sun Gear Thrust Plate and Bearing Kit
9	Kickdown Flex Band	33	Rear Planet to Rear Ring Gear Thrust Plate		
9A	High / Reverse Drum	34	Low and Reverse Band	56	Overdrive Sun Gear Bushing
10	Front Clutch Drum Bushing	35	Reverse Drum Thrust Washer	57	Overdrive Sun Gear
11	Seal	36	Reverse Drum with Lip	58	Overdrive Planetary
11A	High / Reverse Piston	37	Overrun Clutch Inner Race	59	Overdrive Clutch Race
12	High / Reverse Friction	38	Overrun Clutch Roller and Spring	60	Direct Roller Cam to Output Shaft Bearing
13	High / Reverse Steel	39	Overrun Clutch Cam Repair Kit	61	Overdrive Annulus (Ring) Gear
14	High / Reverse Pressure Plate	39A	HD Band Strut	62	Overdrive Clutch Roller Assembly
15	Front to Rear Clutch Hub Thrust Washer	39B	4.2 Ratio Band Lever	63	Output Shaft Bushing (Large)
16	Input Shaft Sealing Ring	39C	Steel Band Anchor	64	Output Shaft Bushing (Small)
16A	Input Shaft & Direct Hub	40	Extension Housing Gasket	64A	Output Shaft
17	Rear (Forward) Clutch Return Spring	40A	Intermediate Shaft	65	Output Shaft Bearing (Front Ball Bearing)
18	Rear (Forward) Clutch Piston Spacer	41	Overdrive Piston Retainer to Case Gasket	66	Governor Support
19	Forward Reaction Plate (Beveled)	42	Overdrive Piston Retainer	67	Output Shaft Bearing (Rear Ball Bearing)
20	Forward (Rear) Friction	43	Overdrive Piston Thrust Plate	68	Output Shaft Bearing Cover Gasket
21	Forward (Rear) Steel	44	Overdrive Piston to Direct Clutch Hub Bearing	69	Extension Housing Bushing
22	Forward Clutch Pressure Plate	45	Overdrive Pressure Plate	70	Extension Housing Bushing Metal Clad Seal
23	Intermediate Shaft Thrust Washer	46	Overdrive Friction (High Energy Waved)		
24	Intermediate Shaft Race	47	Overdrive Steel		

CHRYSLER A518 / A618 / 46RH / 47RH / 48RE PERFORMANCE PARTS

Manufactured In-House by TCS Products

A518 / A618 Dual Ring Kick-Down Servo Product #123001

- * Billet aluminum, zero leakage 2nd gear apply.
- * Longer band life and 3rd gear clutch life!

A518 / A618 Billet Aluminum Dual Ring "Zero Leakage" Accumulator Piston Product #123002

A618 Four Spool Switch Valve Product #12886G

- * Replaces the OEM switch valve.
- * Made by TCS this valve improves the timing and flow to the TCC apply and release circuits.

A518 / A618 Lock-Up Input Shaft & Hub Product #129600L

- * Designed for higher horsepower engines.
- * Shaft machined from 300 Maraging AMS 6514 material then heat treated for torsional strength and, precision ground at all critical diameters.
- * Hub is machined from 4140 HTSR steel.
- * Shaft to hub splines have been increased from O.E.M. 28 to 35 splines to give 25% MORE Surface Contact.



CHRYSLER A518 / A618 / 46RH / 47RH / 48RE PERFORMANCE PARTS

Manufactured In-House by TCS Products

A518 Non Lock-Up Input Shaft & Hub Product #129600N

- * Designed for higher HP engines.
- * Shaft machined from 300 Maraging AMS 6514 material then Heat Treated for torsional strength and, Precision Ground at all critical diameters.
- * Hub is machined from 4140 HTSR steel.
- * Shaft to Hub Splines ave been increased from O.E.M. 28 to 35 splines to give 25% MORE Surface Contact.



A518 / A618 Intermediate Shaft Product #129700

- * Designed for higher horsepower engines.
- * Made from superior strength steel.
- * Heat treated for superior surface toughness and durability.
- * Increased radius in critical areas.
- * Much stonger then the OEM intermediate shaft.



A518 / A618 4.2 Ratio Band Lever Product #146900

- * Provides greater mechanical clamping force than the OEM 3.8 ratio lever.
- * CNC machined from 4140 heat treated HTSR for added strength.



A518 / A618 Heavy Duty Band Strut Product #22717HD

TCS has a solution for Chrysler Automatic transmissions that tend to be prone to Band Strut failure. The OEM Band Struts, manufactured from steel by stamping are notorious for bending causing excessive Band clearances that can potentially contribute to premature transmission failure.

- * The TCS heavy duty band strut is made from case hardened 1018 carbon steel to provide a more durable product.
- * The band is 100% thicker (.240" versus .120") than the OEM product.



A518 / A618 Billet Band Anchor Product #22718HD

Repalce that worn out OEM band anchor with the TCS Products billet steel anchor for heavy duty and high performance applications.

- * This heat treated and zinc plated anchor compliments our other billet parts for the direct band - the TCS 4.2 ratio band lever (part# 146900) and our heavy duty band strut (part# 22717HD).
- * Add reliability and more accurate band adjustments.



A518 / A618 Heavy Duty 4X4 Billet Output Shaft Product #618100

- * Manufactured in house by TCS for the A518/618 transmission.
- * There is no better quality available in todays market.
- * 100% bolt-in installation - "No modifications required at all".
- * Output shaft is machined from a select grade of superior strength steel.
- * All critical areas have been precision ground.
- * The Radii has been increased to further protect areas prone to stress fracture.



CHRYSLER A518 / A618 / 46RH / 47RH / 48RE PERFORMANCE PARTS

Manufactured In-House by TCS Products

A518 / 47RH Heavy Duty 4X4 Billet Output Shaft (Hydraulic Transmission) Product #618101

- * Designed for the hydraulic governor style transmission.
- * Output shaft is precision machined from high strength heat treated steel.
- * The Radius has been increased to further protect areas prone to stress fractures.

A518 / A618 Heavy Duty 4X4 Billet Output Shaft (Electronic Transmission) Product #618102

- * Increased shaft diameter from 1.230" to 1.480" for added strength.
- * Output shaft has been precision machined from high performance steel.
- * The Radius has been increased to further protect areas prone to stress fractures.

NOTE: This unit **MUST** be used with a 29 spline transfer case.

A518 / A618 Clutch Power Pack Kit (Direct Drum) Product #K123900P

HOLD YOUR POWER by installing this kit and add one more clutch plate to the 3rd gear drum. Also the billet aluminum clutch piston is more concentric than the O.E. cast piston resulting in a more positive clutch application.

- * A more stable piston apply and more friction area = Greater Performance and Longer Durability.
- * Raybestos frictions and steels are used with this kit.

A518 / A618 Billet Steel Front Drum & Piston Product #K123900SH

The drum has been CNC machined at TCS from AIAI/SAE 1040-1045 medium-carbon machinery steel - NO Cast Iron used in this one!

- * Ideal for Street Use.
- * Will hold 5-6 friction plates versus 4 in a stock unit.
- * 55% MORE piston apply area! This results in double the clamping force needed in 3rd gear.
- * Engineered with dual oil apply passages for even piston apply.
- * Kit comes with a new billet aluminum piston.

A518 / A618 Pump Gear Set Product #K22965

- * Hardened and precision machined inner and outer front pump gears.
- * Reduces fluid leakages between the gears and the pump housing.

A518 / A618 Billet Combo Kit Product #K1469CP

TCS Products has packaged together all of the billet finishing parts for the A727/518/618 transmissions under one part number - K1469CP.

The kit contains the TCS dual ring servo and accumulator piston - for zero leakage, the quick ratio 4.2 band lever, the unbendable HD band strut and, our newest addition the billet band anchor - for positive band adjustment.

